

ULTRA-LOCK MOTOR SETTINGS

STEP 1 – INITIAL SETUP

PAIR MOTOR WITH CONTROLLER

Select channel on controller.



Hold **P1** button on motor head.

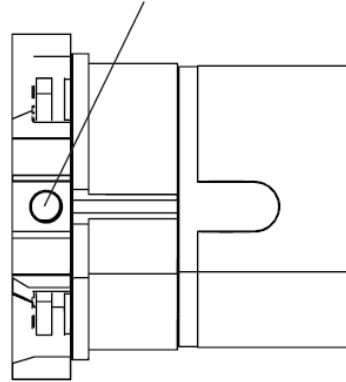

Hold **STOP** on controller.



IMPORTANT

Consult user manual for your controller for information on selecting channel.

Motor Response



Motor Response



Motor is now in step mode and ready for setting limits.

CHECK FOR MOTOR DIRECTION

To check travel direction of shade, press **UP** or **DOWN** on controller

To reverse shade direction, hold both **UP** and **DOWN**. Until the motor responds

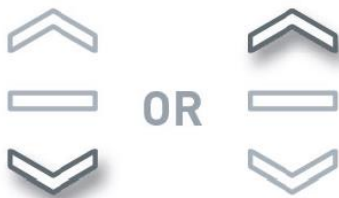

IMPORTANT

Damage to shade may occur when operating motor prior to setting limits. Attention should be given.



IMPORTANT

Reversing motor direction using this method is only possible during initial set-up.

STEP 2 – SET UPPER LIMIT

Setting limits with this method is only possible during initial set up. Refer to previous page for adjusting motor limits.

Move shade to the desired highest position by pressing the **UP** button on controller

To save upper limit, hold **UP** and **STOP**



IMPORTANT

Cycle shade up and down prior to setting limits fabric.



Initial set-up is not complete.

Motor Response

Approx.



JOG X2



BEEP X3



IMPORTANT

After setting limits, motor will automatically exit from initial set-up mode.

STEP 3 – SET LOWER LIMIT (LOCK POSITION)

Setting limits with this method is only possible during initial set up. Refer to Part J for adjusting motor limits.



IMPORTANT

The motor lower limit must be set correctly between the locking & unlocking position. Jog the motor down to find the lock position (Jog until you hear BOTH pins click), then set the lower limit.

Move shade to lock position by pressing the **DOWN** button on controller.

To save lower limit, hold **DOWN** and **STOP**.



Motor Response

Approx.



JOG X2



BEEP X3

STEP 4 – ACTIVATE FABRIC TENSION MODE

Once the bottom limit is set, FT Mode will need to be activated to operate the Ultra-Lock.

Press **P2** on controller.



Press UP on controller.



Press UP on controller.

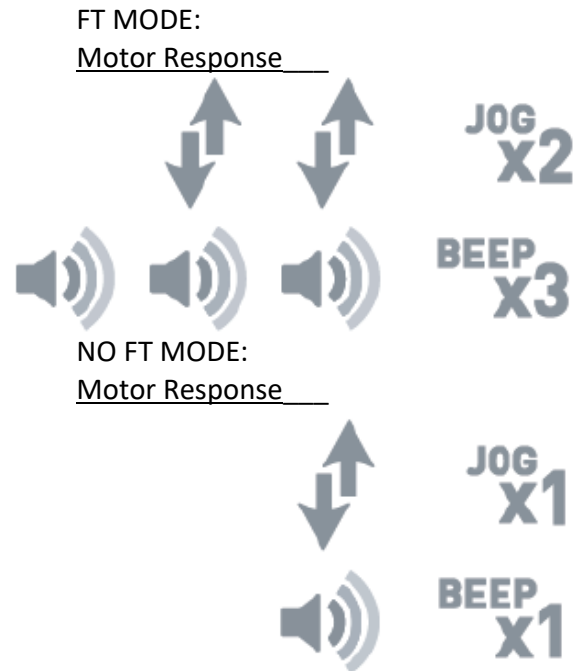

IMPORTANT

Initial setup is complete. You may now operate the shade normally.

ULTRA-LOCK OPERATION (MOTOR OPERATION)

STEP 1 – LOCKING

Press **DOWN** on the controller. The motor will lower the weight bar to the set bottom limit, then automatically tension the fabric.



STEP 2 – UNLOCKING

Press **UP** on the controller. The motor will lower the weight bar past the bottom limit to unlock, then raise the weight bar continuing to the upper limit.



Note: Make sure that the FT mode is turned ON whilst locking and unlocking the blind. Refer to step 4 for instructions.

ADJUSTING MOTOR LIMITS

STEP 1 – ADJUST UPPER LIMIT

Hold **UP** and **STOP** on controller.



Move shade to the desired highest position by pressing the **UP** button.



To save upper limit, hold **UP** and **STOP**.



Motor Response

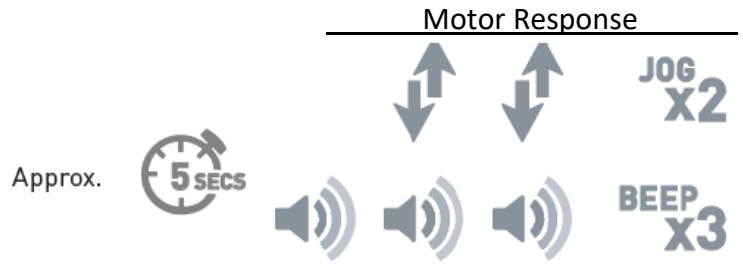

STEP 2 – ADJUST LOWER LIMIT (LOCK POSITION)



IMPORTANT

The motor lower limit must be set correctly between the locking & unlocking position. Jog the motor down to find the lock position (Jog until you hear BOTH pins click) then set the lower limit.

Hold **DOWN** and **STOP** on controller.



Move shade to the desired lowest position by pressing the **DOWN** button.



To save lower limit, hold **DOWN** and **STOP**.



Motor Response

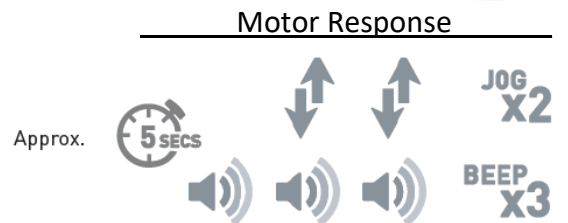
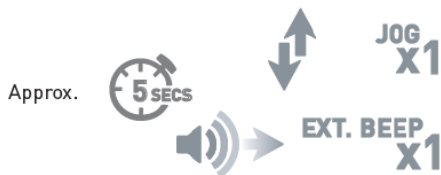

ULTRA-LOCK OPERATION (MANUAL OPERATION)

SPRING CONTROL

LOCKING

STEP 1 - LOWER THE WEIGHT BAR TOWARDS THE LOCK UNTIL YOU HEAR IT CLICK ONCE

If 2 'clicks' are heard the weight bar has been lowered into the 'unlock' position. Raise the weight bar and try again to lock.

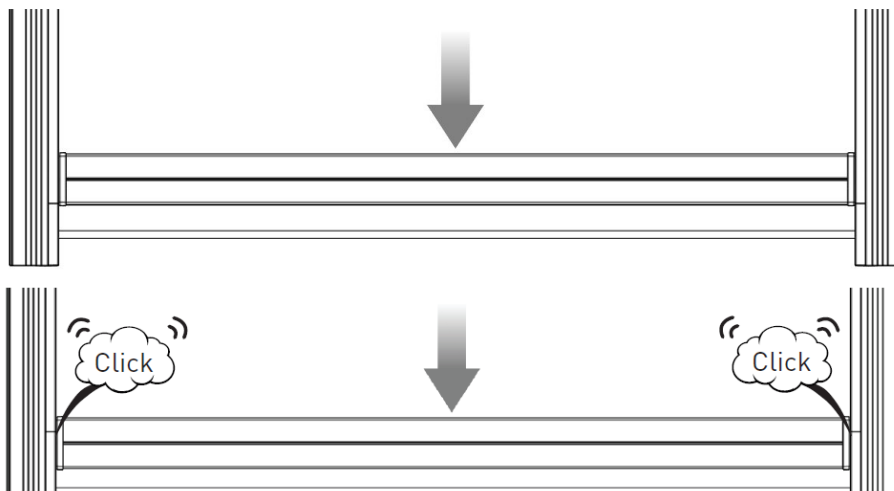

UNLOCKING

STEP 1 - LOWER THE WEIGHT BAR ALL THE WAY DOWN PAST THE LOCKING POINT

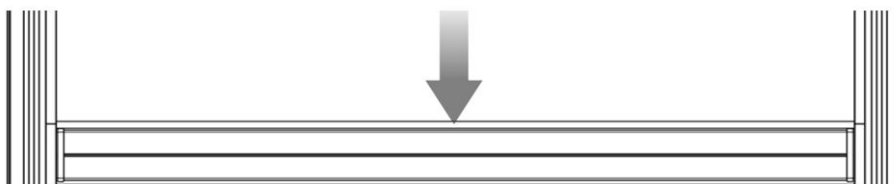

STEP 2 - RAISE THE WEIGHT BAR

