

Installation Guide for Betta 3000 Straight Drop Multi Stop Awning – with Side Channels - Spring Operated

Please Note: These instructions should be read thoroughly before installing.

This is a guide to assist in the installation and care of your external awnings. Betta Blinds and Awnings do not guarantee the accuracy of the information contained in this guide. We recommend an experienced expert installer to rely upon their own skills. This is based on general knowledge concerning the assembly, materials and working process of the external blinds, which is known to us at the time of printing this guide, consequently, is subject to change and Betta Blinds and Awnings specifically reserves the right to change this guide without notification.

Ensure all components are included in your packaging, before proceeding to install:

- Side channels x 2
- Blind
- Spring Tension chart
- Post foot (if required)
- Channel end cap (if required)
- Pull down ring (if required)
- Pull down stick (if required)

You will also need: screws, plugs, drill, hammer drill (if drilling into concrete), measuring tape, spirit level, shifter, rivets, rivet gun (if required), dyna bolts (if required)

If installing on a brick wall NEVER put the screw into a mortar line. If the position you need to drill is over a mortar line move up to the centre of the brick above that position.

1. Check the size of your blind against the label, which will be attached to the packaging.
2. Using your tape measure, mark where to pre-drill your channel. Check if this is level with your spirit level.
3. If FACE fit, attach the side channel with the snap in recess facing outwards. Screw directly through this fixing to post

4. If there is no post to fix to, the side channel can be used as one. Position the side channel where you want it to sit and mark top and bottom areas; ensuring post is level. Drill holes where the post is to be attached on ground and ceiling. Attach foot post to the ground using a Dynabolt or similar. Attach post to ceiling using appropriate bolt or screw, which may also be a Dynabolt. - refer to picture 1



- 4a. Slide side channel over foot posts. Predrill hole, screw through the channel into the top and bottom foot post, making sure this is level.

5. If REVEAL fit, attach the side channel to the inside of the post, with the snap in recess facing backwards. Screw through the channel section onto post

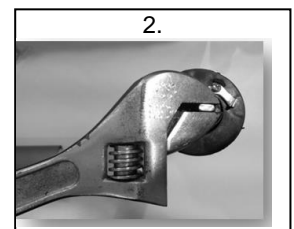

6. If channel end cap is required, place this in bottom of channel with lip sitting flush on channel. This can be fastened with rivet or screw (not provided)

7. Attach a shifter to the Roller Pin. Wind the shifter clockwise to apply tension. Use the size chart (enclosed) to determine how many turns of

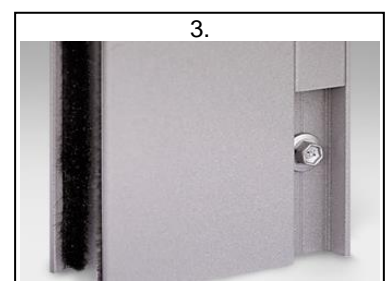

tension are required. Do **NOT** let go of the shifter while tensioning as the spring has a lot of force in it. Do **NOT** try and over tension the spring. When the right amount of tension has been applied, drop the holding tab down and wind the spring back until it engages the pin *refer to picture 2*

8. Install blind into brackets **NB: Spring end/lock off pin should be on the left side.**
9. If FACE fit snap the infill cover plate into the recess *refer to picture 3*
10. Twist bottom rail and roll down.

Caution: Like all outdoor blinds, it is prudent to retract the blind in the presence of strong winds.



Installation Guide for Betta 3000 Straight Drop Multi Stop Awning – with Side Channels & Cassette Headbox - Spring Operated

Please Note: These instructions should be read thoroughly before installing.

This is a guide to assist in the installation and care of your external awnings. Betta Blinds and Awnings do not guarantee the accuracy of the information contained in this guide. We recommend an experienced expert installer to rely upon their own skills. This is based on general knowledge concerning the assembly, materials and working process of the external blinds, which is known to us at the time of printing this guide, consequently, is subject to change and Betta Blinds and Awnings specifically reserves the right to change this guide without notification.

Ensure all components are included in your packaging, before proceeding to install:

- | | |
|----------------------------------|--|
| ■ Side channels x 2 | ■ Channel end cap <i>(if required)</i> |
| ■ Blind | ■ Pull down ring <i>(if required)</i> |
| ■ Spring Tension chart | ■ Pull down stick <i>(if required)</i> |
| ■ Post foot <i>(if required)</i> | |

You will also need: screws, plugs, drill, hammer drill (if drilling into concrete), measuring tape, spirit level, shifter, rivets, rivet gun (if required), dyna bolts (if required)

If installing on a brick wall NEVER put the screw into a mortar line. If the position you need to drill is over a mortar line move up to the centre of the brick above that position.

1. Check the size of your blind against the label, which will be attached to the packaging.
2. Evenly space & screw cassette brackets to fixing point. The end brackets should be mounted no further than 200mm from the end of the blind. The brackets are universal so can be used for both face and reveal fit.
3. Evenly space & screw cassette brackets to fixing point. The end brackets should be mounted no further than 200mm from the end of the blind. The brackets are universal so can be used for both face and reveal fit.
4. Raise and snap the cassette into the brackets working from one side to the other until all brackets are snapped into place. With an Allen key tighten grub screws on all brackets so cassette does not fall.
5. Using your tape measure, mark where to pre-drill your channel. Check if this is level with your spirit level.

6. If FACE fit, attach the side channel with the snap in recess facing outwards. Screw directly through this fixing to post.

6a. If there is no post to fix to, the side channel can be used as one. Position the side channel where you want it to sit and mark top and bottom areas; ensuring post is level. Drill holes where the post is to be attached on ground and ceiling. Attach foot post to the ground using a Dyna bolt or similar. Attach post to ceiling using appropriate bolt or screw, which may also be a Dyna bolt. - refer to picture 1

6b. Slide side channel over foot posts. Predrill hole, screw through the channel into the top and bottom foot post, making sure this is level.



7. If REVEAL fit, attach the side channel to the inside of the post, with the snap in recess facing backwards. Screw through the channel section onto post

8. If channel end cap is required, place this in bottom of channel with lip sitting flush on channel. This can be fastened with rivet or screw (not provided)

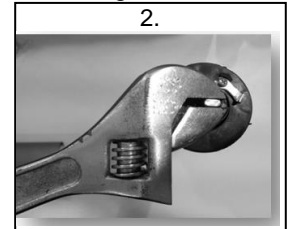

9. The spring has already been pre-tensioned but may need adjusting. See step 10.

10. Take cassette front cover off by removing screws from end cap. Attach a shifter to the Roller Pin. Wind the shifter clockwise to apply tension. Use the size chart (enclosed) to determine how many turns of tension are required. Do **NOT** let go of the shifter while tensioning as the spring has a lot of force in it. Do **NOT** try and over tension the spring. When the right amount of tension has been applied, drop the holding tab down and wind the spring back until it engages the pin refer to picture 2

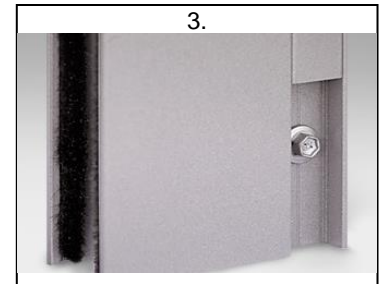

11. If FACE fit snap the infill cover plate into the recess refer to picture 3

12. Twist bottom rail to release and roll down and twist again to lock into place.

Caution: Like all outdoor blinds, it is prudent to retract the blind in the presence of strong winds.