

Installation Guide for Betta 2000 Auto Lock Arm Awning with Guide Bars without Weather Box (hood)

Please Note: These instructions should be read thoroughly before installing.

This is a guide to assist in the installation and care of your external awnings. Betta Blinds and Awnings do not guarantee the accuracy of the information contained in this guide. We recommend an experienced expert installer to rely upon their own skills. This is based on general knowledge concerning the assembly, materials and working process of the external blinds, which is known to us at the time of printing this guide, consequently, is subject to change and Betta Blinds and Awnings specifically reserves the right to change this guide without notification.

Ensure all components are included in your packaging, before proceeding to install:

- | | |
|------------------|---------------------------------|
| ■ Guide bars x 2 | ■ Pull down stick (if required) |
| ■ Brackets x 2 | ■ Pull down ring (if required) |
| ■ L Brackets x 2 | ■ Blind |
| ■ Arms x 2 | |

You will also need: screws, plugs, drill, hammer drill (if drilling into concrete), measuring tape, spirit level and shifter.

If installing on a brick wall NEVER put the screw into a mortar line. If the position you need to drill is over a mortar line move up to the centre of the brick above that position.

1. Check the size of your blind against the label, which will be attached to the packaging.
2. Install Brackets - The outside measurement from bracket to bracket is the OPEN size, it is the width of your blind. Mark where the control end bracket is to be installed along with the idle end bracket. Drill, plug and attach brackets. Ensure that the positions where the fasteners run through the brackets are secured into brick, or into the wall's structural support. **NB: Ensure that the brackets are fitted level horizontally.**
3. For installing guides, measure 18mm in from outside of bracket. If using 150mm arm, measure vertically 50mm from bottom of bracket and mark; this is where your top screw on your guide is to be attached. If using 300mm arm, measure vertically 170mm from bottom of bracket; this is where your top screw on your guide is attached. This will be where your top screw is to be fixed.
4. Drill, plug and loosely secure the top screw only, on your Guide Bars. Make sure the Guide Bar is running parallel to the window.
5. Slide the L Bracket onto the Guide Bar. Position the L Bracket on the wall so that the top of the L Bracket is level with the windowsill. Mark this position.
6. Take L bracket off guide and detach guide. Drill, plug and attach L bracket on marked area to wall.
7. Slide arm onto guide bar, with the tail end on the bottom. Slide guide bar through L bracket and attach to wall *refer to picture 2.*

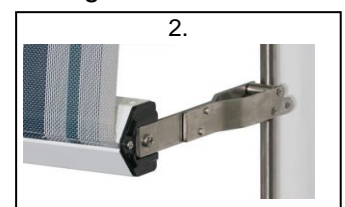

8. Attach a shifter to the Roller Pin. Wind the shifter clockwise to apply tension. Use the size chart (enclosed) to determine how many turns of tension are required. Do **NOT** let go of the shifter while tensioning as the spring has a lot of force in it. Do **NOT** try and over tension the spring. When the right amount of tension has been applied, drop the holding tab down and wind the spring back until it engages the pin - refer to picture 3.

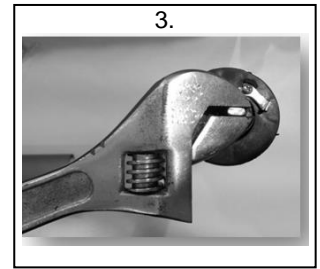

9. Install blind into brackets **NB: Spring end/lock off pin should be on the right side.**

10. To operate pull down bottom bar. To put blind up, push bottom bar down and twist up (in one motion).

Caution: Like all outdoor blinds, it is prudent to retract the blind in the presence of strong winds.

Installation Guide for Betta 2000 Auto Lock Arm Awning with Guide Bars with Weather Box (Hood)



Please Note: These instructions should be read thoroughly before installing.

This is a guide to assist in the installation and care of your external awnings. Betta Blinds and Awnings do not guarantee the accuracy of the information contained in this guide. We recommend an experienced expert installer to rely upon their own skills. This is based on general knowledge concerning the assembly, materials and working process of the external blinds, which is known to us at the time of printing this guide, consequently, is subject to change and Betta Blinds and Awnings specifically reserves the right to change this guide without notification.

Ensure all components are included in your packaging, before proceeding to install:

- | | |
|------------------|---------------------------------|
| ■ Guide bars x 2 | ■ Weather Box End caps x 2 |
| ■ L Brackets x 2 | ■ Rivets x 6 (for weather box) |
| ■ Arms x 2 | ■ Pull down stick (if required) |
| ■ Blind | ■ Pull down ring (if required) |
| ■ Weather Box | |

You will also need: screws, plugs, drill, hammer drill (if drilling into concrete), rivet gun, measuring tape, spirit level and shifter.

If installing on a brick wall NEVER put the screw into a mortar line. If the position you need to drill is over a mortar line move up to the centre of the brick above that position.

1. Check the size of your blind against the label, which will be attached to the packaging.

2. Fitting the Weather Box (Hood)

2a. Remove the roller from the weather box.

2b. Attach end caps to hood using rivets supplied (3 at each end).

2c. Measure the width of the hood then the width of the window. The difference between the two is the total amount of overhang your hood will have. Divide this number by two to determine how much overhang you will have on each side. E.G. If the hood measures 2300 and the window measures 2000, the total overhang will be 300mm. dividing by two equals 150mm each side of the window.

- 2d. Carefully raise the hood into position ensuring that it is horizontal. Mark the top drill hole through the eyelet - *refer to picture 1.* →
Mark your bottom hole, which is the second bottom hole.

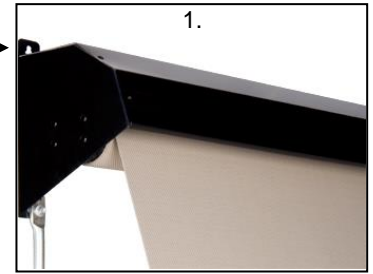

- 2e Pre-drill all holes and plug. When all holes are drilled, carefully position the hood, and fasten with screws.

3. For installing guides: if using 150mm arm, this is attached to bottom hole of the hood as per Pic 1. If using 300mm arm, measure vertically 170mm from bottom of hood and mark.

4. Drill, plug and loosely secure the top screw only, on your Guide Bars. Make sure the Guide Bar is running parallel to the window.

5. Slide the L Bracket onto the Guide Bar. Position the L Bracket on the wall so that the top of the L Bracket is level with the windowsill. Mark this position. Take L bracket off guide and detach guide. Drill, plug and attach L bracket on marked area to wall.

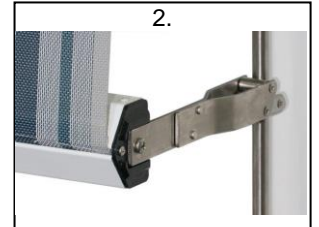

6. Slide arm onto guide bar, with the tail end on the bottom. Slide guide bar through L bracket and attach to wall *refer to picture 2.*

7. Attach a shifter to the Roller Pin. Wind the shifter clockwise to apply tension. Use the size chart (enclosed) to determine how many turns of tension are required. Do **NOT** let go of the shifter while tensioning as the spring has a lot of force in it. Do **NOT** try and over tension the spring. When the right amount of tension has been applied, drop the holding tab down and wind the spring back until it engages the pin - *refer to picture 3.*

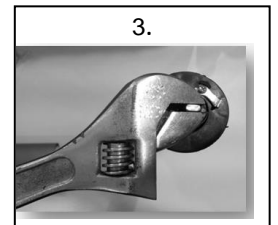

8. Install blind into brackets **NB: Spring end/lock off pin should be on the right side.**

9. To operate pull down bottom bar. To put blind up, push bottom bar down and twist up (in one motion).

Caution: Like all outdoor blinds, it is prudent to retract the blind in the presence of strong winds.