

Installation Guide for Betta 1000 – Straight Drop Awning Spring Operated without Weather Box (Hood)

Please Note: These instructions should be read thoroughly before installing.

This is a guide to assist in the installation and care of your external awnings. Betta Blinds and Awnings do not guarantee the accuracy of the information contained in this guide. We recommend an experienced expert installer to rely upon their own skills. This is based on general knowledge concerning the assembly, materials and working process of the external blinds, which is known to us at the time of printing this guide, consequently, is subject to change and Betta Blinds and Awnings specifically reserves the right to change this guide without notification.

Ensure all components are included in your packaging, before proceeding to install:

- | | |
|----------------------------|---------------------------------|
| ■ Universal Brackets x 2 | ■ Blind |
| ■ Hooks / buttons x 2 | ■ Spring Tension diagram |
| ■ Saddles x 2 | ■ Pull down stick (if required) |
| ■ Rivets x 4 (for saddles) | ■ Pull down ring (if required) |

You will also need: screws, plugs, drill, hammer drill (if drilling into concrete) measuring tape, spirit level, stainless screws, rivets, rivet gun and 6-gauge x 25mm screws (for fixing bottom saddles)

If installing on a brick wall NEVER put the screw into a mortar line. If the position you need to drill is over a mortar line move up to the centre of the brick above that position.

1. Check the size of your blind against the label, which will be attached to the packaging.
2. Install Brackets - The outside measurement from bracket to bracket is the OPEN size, it is the width of your blind. Mark where the control end bracket is to be installed and the idle end. Drill, plug and attach brackets. Ensure that the positions where the fasteners run through the brackets are secured into brick, or into the wall's structural support. **NB: Ensure that the brackets are fitted level horizontally.**
3. Attach saddles to bottom bar on the back straight edge. These need to be horizontal. This will be the same measurement as the bottom hooks (step 7). If using bungee cord loops these are attached at the end of the bottom rail.
4. Attach a shifter to the Roller Pin. Wind the shifter clockwise to apply tension. Use the size chart (enclosed) to determine how many turns of tension are required. Do **NOT** let go of the shifter while tensioning as the spring has a lot of force in it. Do **NOT** try and over tension the spring. When the right amount of tension has been applied, drop the holding tab down and wind the spring back until it engages the pin - refer to picture 1.
5. Install blind into brackets **NB: Spring end/lock off pin should be on the left side.**
6. Attach hooks/bungee buttons to bottom fixing point with screws (which are not provided). **NB: This measurement must be the same as saddles or bungee cord from step 3 - refer to picture 2.**
7. Pull blind down and slip over hooks or bungee buttons.

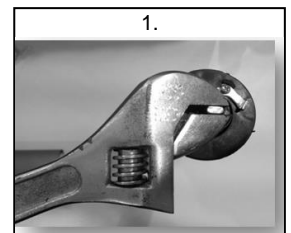

Caution: Like all outdoor blinds, it is prudent to retract the blind in the presence of strong winds.



Installation Guide for Betta 1000 Straight Drop Awning Spring Operated with Weather Box (Hood)

Please Note: These instructions should be read thoroughly before installing.

This is a guide to assist in the installation and care of your external awnings. Betta Blinds and Awnings do not guarantee the accuracy of the information contained in this guide. We recommend an experienced expert installer to rely upon their own skills. This is based on general knowledge concerning the assembly, materials and working process of the external blinds, which is known to us at the time of printing this guide, consequently is subject to change and Betta Blinds and Awnings specifically reserves the right to change this guide without notification.

Ensure all components are included in your packaging, before proceeding to install:

- | | |
|----------------------------|-------------------------------|
| Weather Box | Rivets x 4 (for saddles) |
| Weather Box end caps x 2 | Pull down stick (if required) |
| Rivets for weather box x 6 | Pull down ring (if required) |
| Hooks and saddles x 2 | Blind |
| Buttons x 2 | Spring Tension diagram |

You will also need: screws, rivets, plugs, drill, hammer drill (if drilling into concrete), measuring tape, spirit level, shifter, rivet gun and 6-gauge x 25mm screws (for fixing bottom saddles)

If installing on a brick wall NEVER put the screw into a mortar line. If the position you need to drill is over a mortar line move up to the centre of the brick above that position.

1. Check the size of your blind against the label, which will be attached to the packaging.
2. **Fitting the Weather Box (Hood)**
 - 2a. Remove the roller from the weather box.
 - 2b. Attach end caps to hood, using rivets supplied.
 - 2c. Measure the width of the hood then the width of the window. The difference between the two is the total amount of overhang your box will have. Divide this number by two to determine how much overhang you will have on each side. E.g. If the hood measures 2300 and the window measures 2000, the total overhang will be 300mm. dividing by two equals 150mm each side of the window.
 - 2d. Carefully raise the hood into position ensuring that it is horizontal.
Mark the top drill hole through the eyelet - *refer to picture 1.*
Mark your bottom hole, which is the second bottom hole.
NOTE: Auto Lock Awning shown in Pic 1, Straight Drop Awnings are Under Roll
 - 2e. Pre-drill all holes and plug. When all holes are drilled, carefully position the weather box, and fasten with screws. Check if this is level with your spirit level.
3. If required, attach pull down ring to back of bottom bar.



4. Attach saddles to bottom bar on the back straight edge. These need to be horizontal. This will be the same measurement as the bottom hooks (step 7). If using bungee cord loops these are attached at the end of the bottom rail.



5. Attach a shifter to the Roller Pin. Wind the shifter clockwise to apply tension. Use the size chart (enclosed) to determine how many turns of tension are required. Do **NOT** let go of the shifter while tensioning as the spring has a lot of force in it. Do **NOT** try and over tension the spring. When the right amount of tension has been applied, drop the holding tab down and wind the spring back until it engages the pin *refer to picture 1*.

6. Install blind into brackets **NB: Spring end/lock off pin should be on the left side.**



7. Fix hooks/bungee button to bottom fixing point with screws (which are not provided)
NB: This measurement must be the same as saddles/bungee cords from step 4 - refer to picture 2

8. Pull blind down and slip over hooks or bungee buttons.

Caution: Like all outdoor blinds, it is prudent to retract the blind in the presence of strong winds.